







User Manual

Accessory Box Content

 PSU Screw × 4	 Motherboard & SSD Screw × 20
 M/B Stand-off × 2	 HDD Screw × 8
 Fan Screw × 12	 Fan Screw A × 2

A Water Cooling Radiator Options

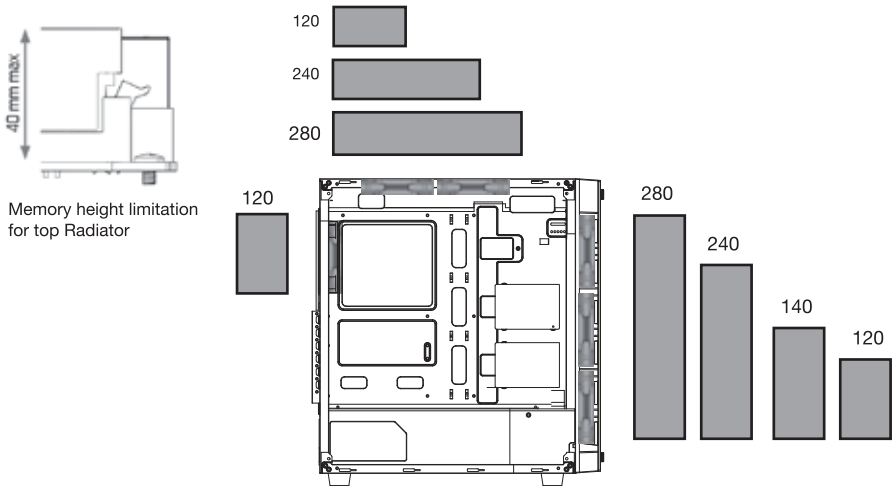

B Possible Fan Cooling Locations

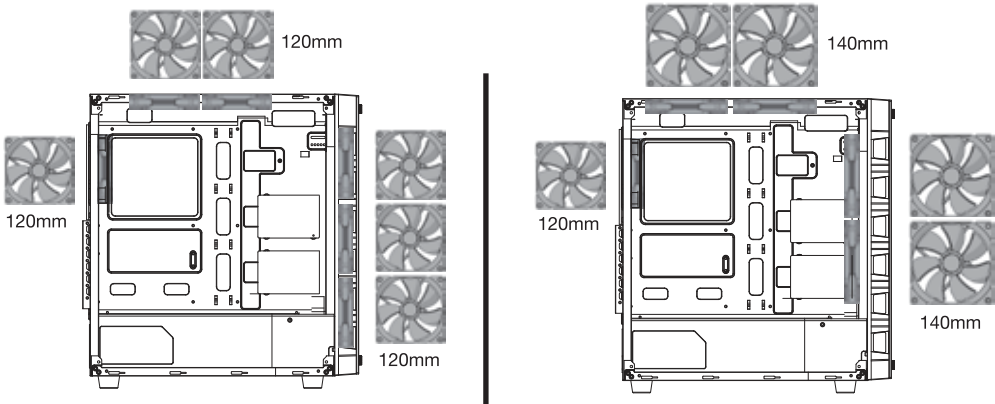

C Dust Maintenance

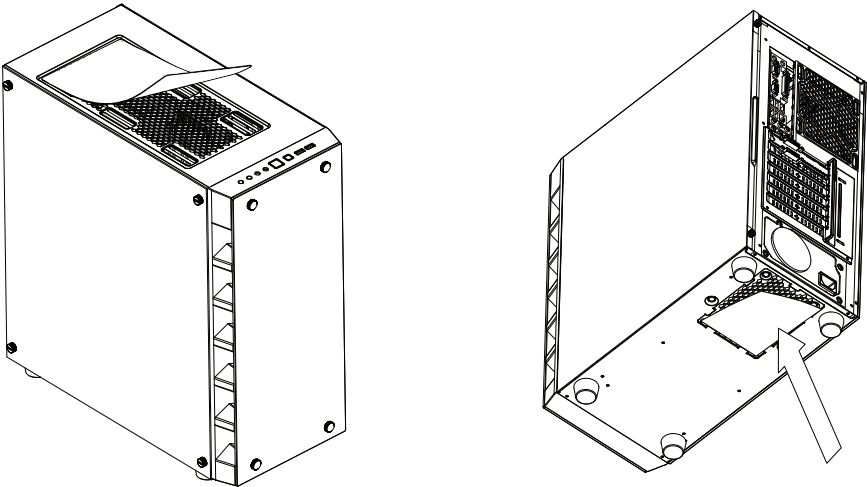

D CPU Cooler Limitations E Graphics Card Limitations

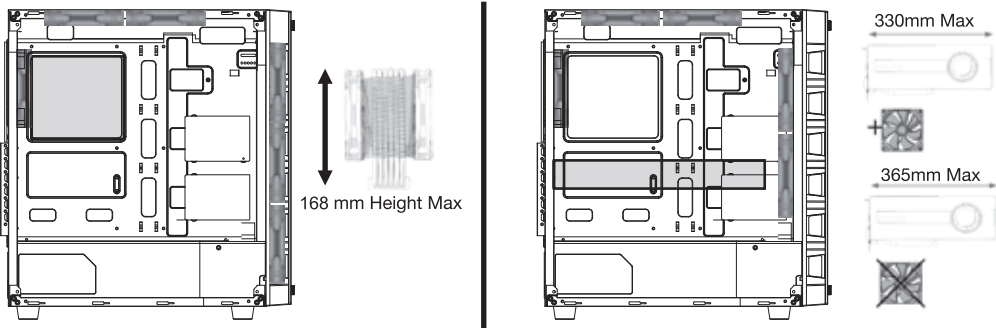

1 Remove Side Panels

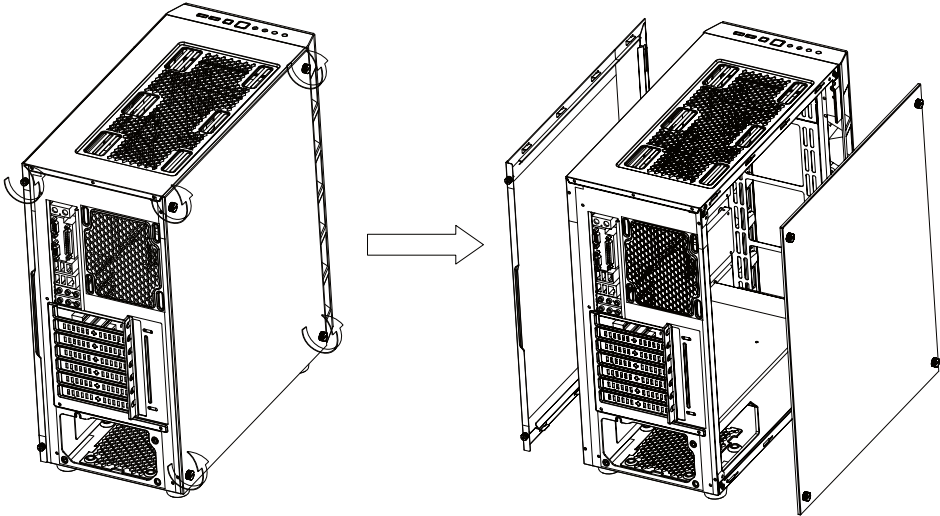

2 Install the Power Supply

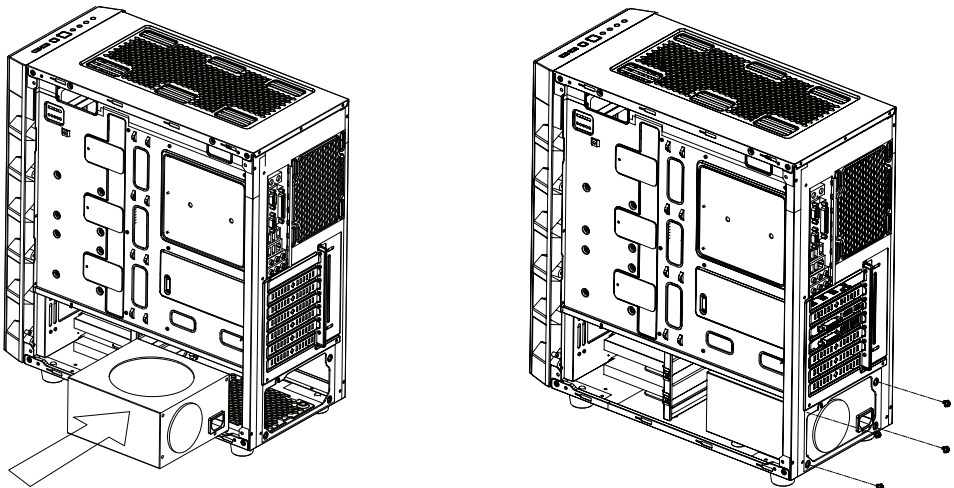

3 Motherboard Preparation

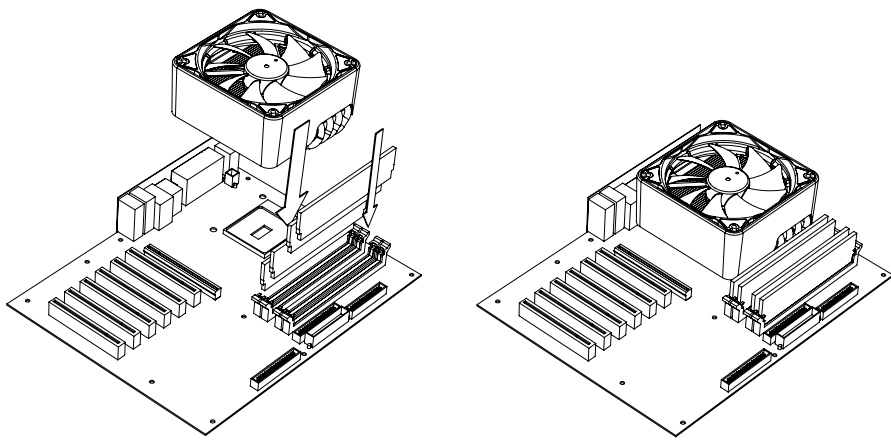

4 Install the Motherboard

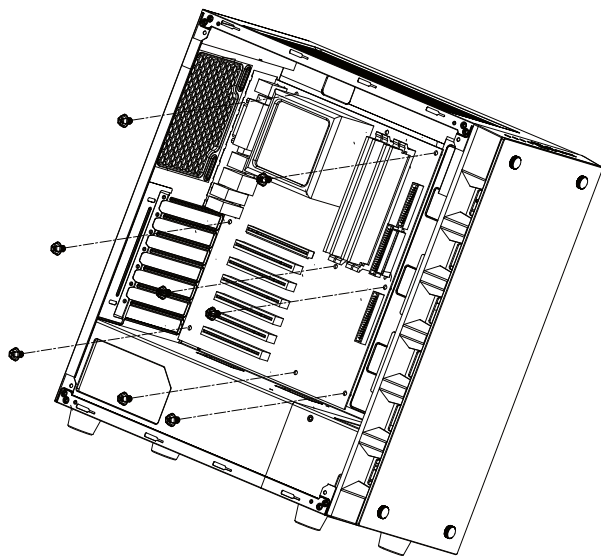

5 Install The PCI Graphics Card

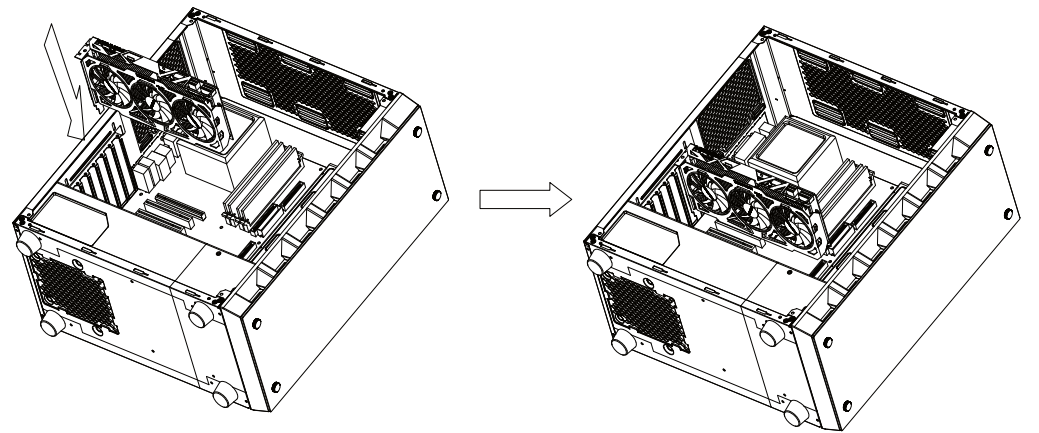

6 Connect Cables for Front I/O and Fans

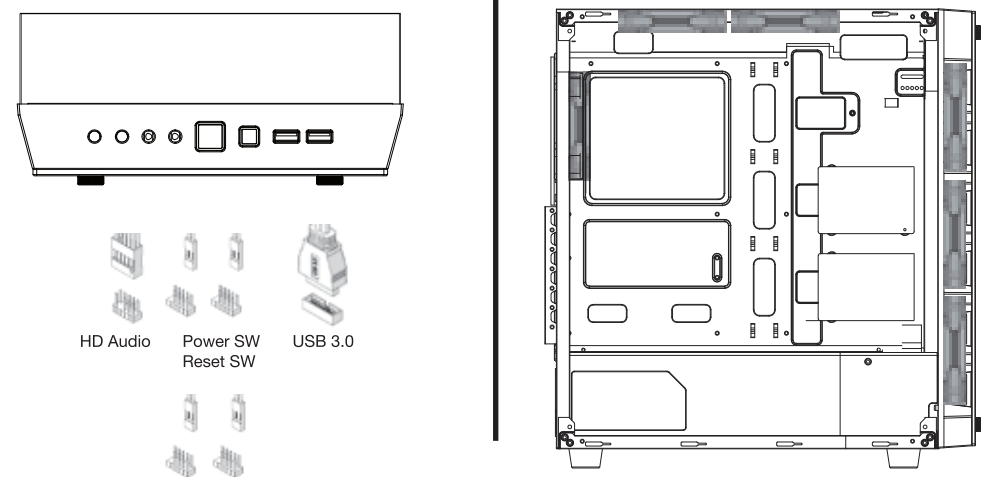

7 Install 3.5" or 2.5" Drive

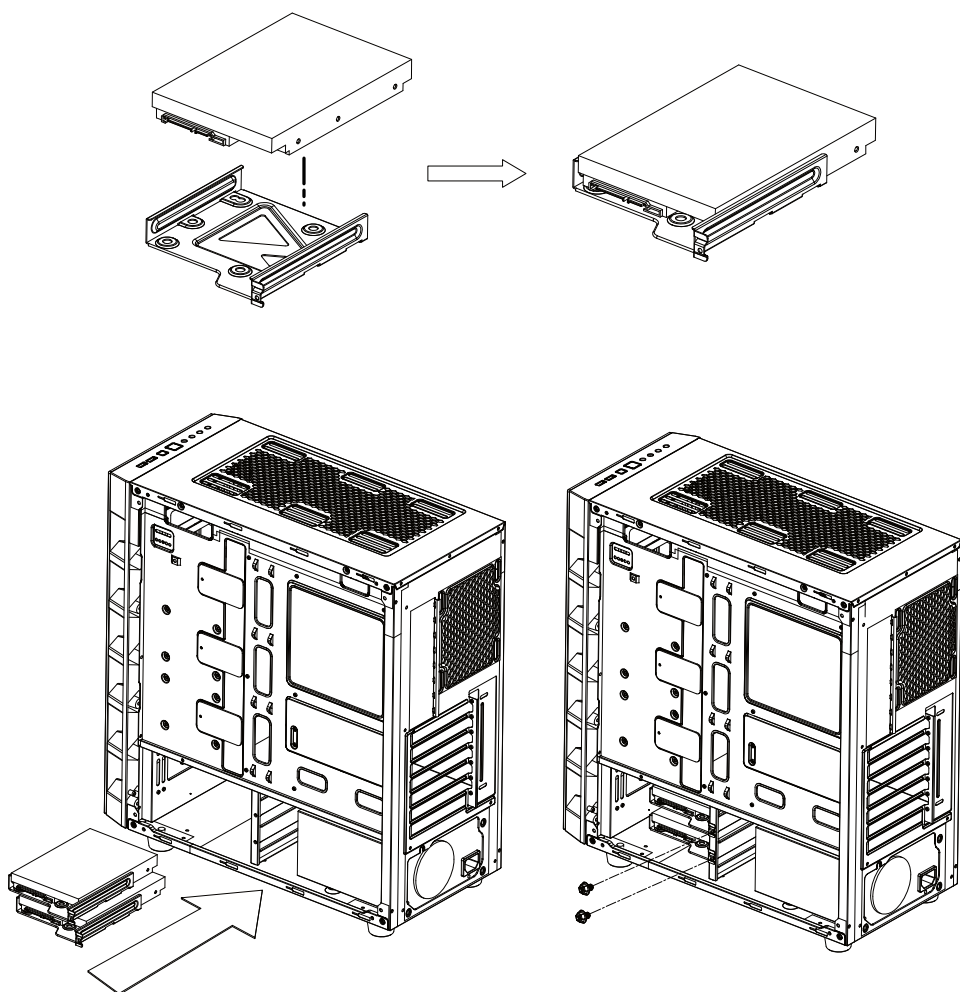

8 Install The 2.5" Drives

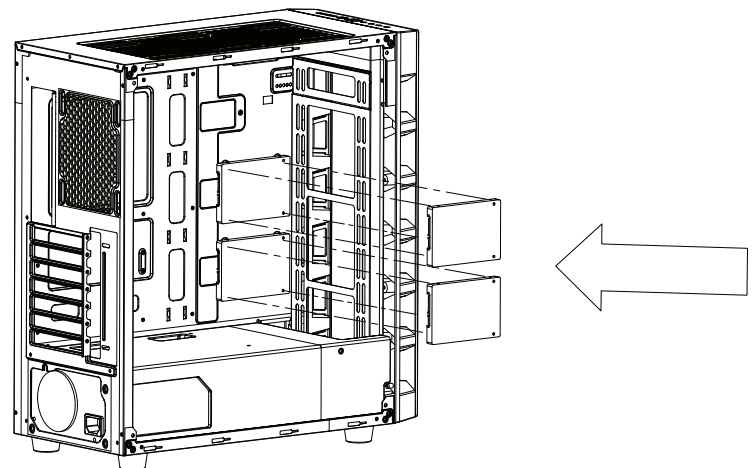

Limits of Warranty:

Warranty coverage does not include the following:

- A faulty product that leads to harm or damage to other products
- Damage of product as a result of other product components
- Incorrect method of operation or use of product not for intended use
- Any form of alteration to original product
- Inability to install the product as a result of incompatibility with other components.

The Specifications are subject to change without notice.

Please consult our website for further information:

www.gelidsolutions.com

Disclaimer:

In no event shall GELID Solutions its directors or employees be liable for any indirect damages, incidental or consequential damages arising from any defect or error in this manual or product.

© Copyright 2020 All rights reserved by GELID Solutions Limited
All Brand names and Trademarks are the properties of their respective owners.