

## QUICK START GUIDE

### A Installation Parts

1 x Mounting Set

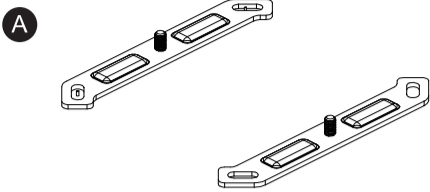

1 x Backplate

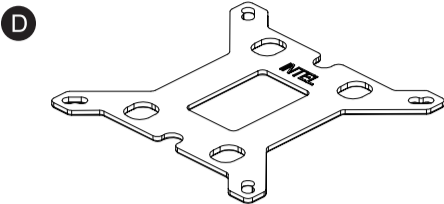

4 x Thumbscrew

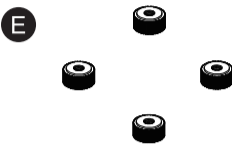

4 x Screw

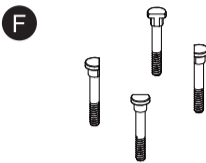

4 x Spacer

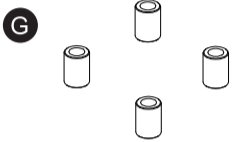

4 x Washer

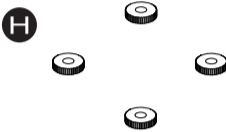

### B Installation Instructions

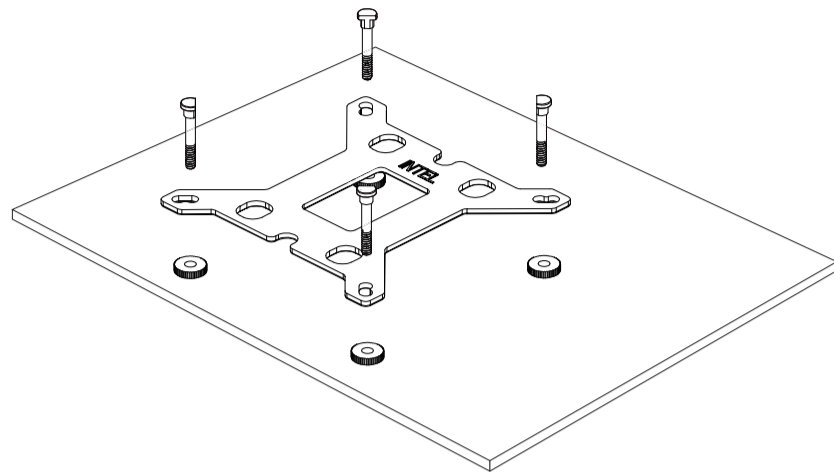

1. Insert 4 x Screw F into the screw holes of Universal Backplate D and fasten 4 x Washer H as shown.
2. Insert the Universal Backplate assembly from the motherboard backside.

### C Installation Instructions

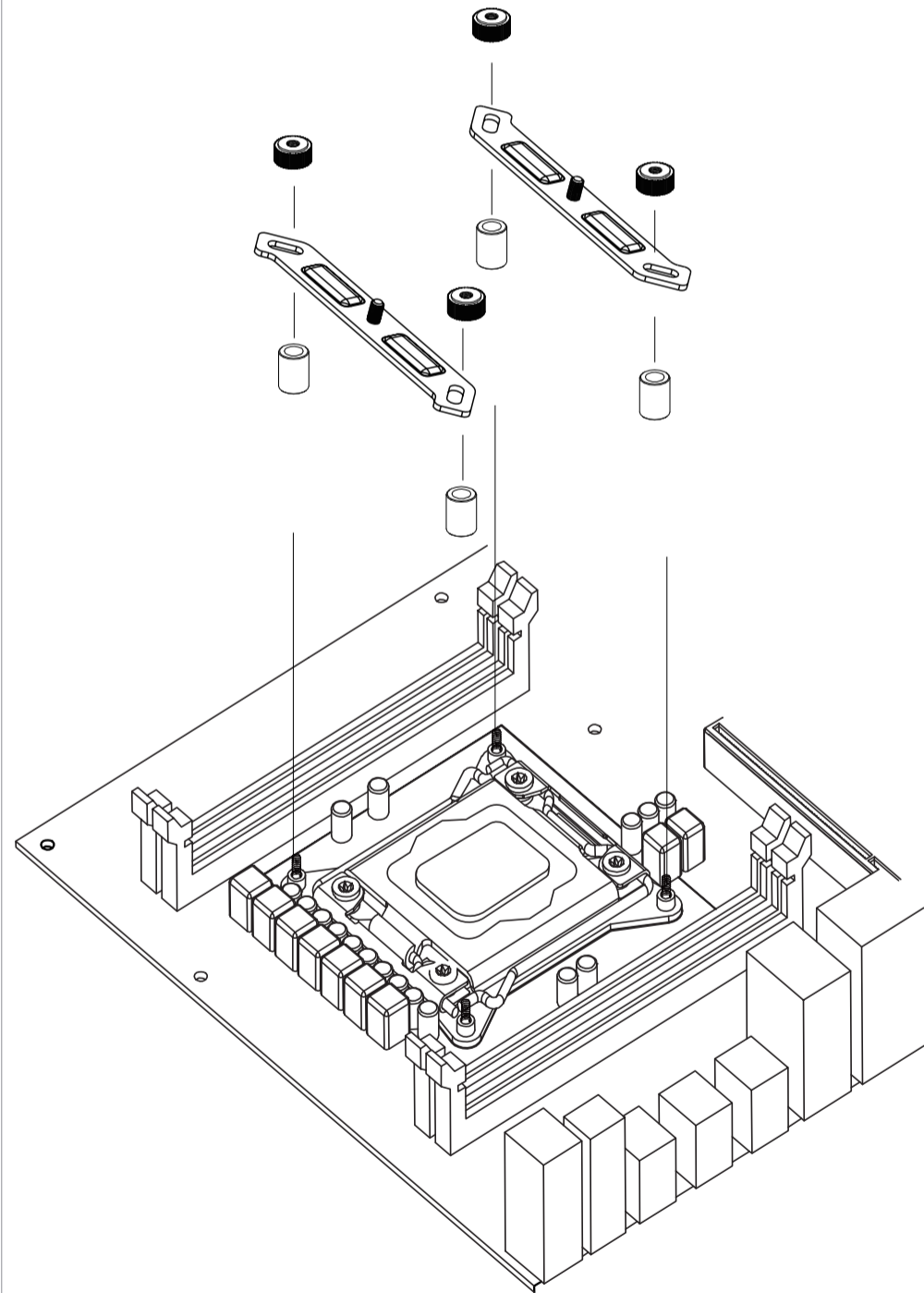

3. Put 4 x Spacer G onto 4 x Screw F as shown.
4. Put the Mounting Set A on top of Spacer G. Tighten 4 x Thumbscrew E on top.

### D Installation Instructions

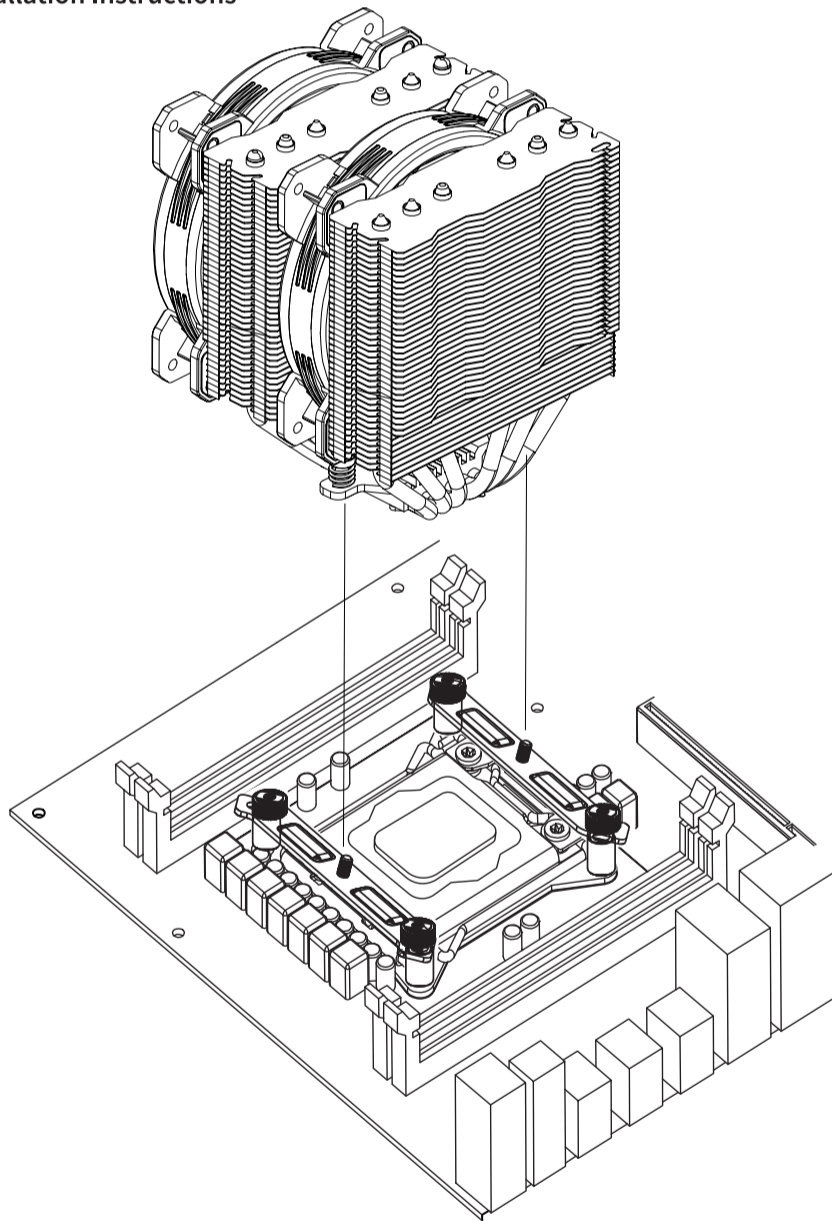

5. Place the heatsink on top of CPU. Tighten the spring-screws with a screwdriver as shown.

#### Limits of Warranty:

Warranty coverage does not include the following:

- A faulty product that leads to harm or damage to other products
- Damage of product as a result of other product components
- Incorrect method of operation or use of the product not for the intended use
- Any form of alteration to the original product
- Inability to install the product as a result of incompatibility with other components.

The Specifications are subject to change without notice.  
Please consult our website for further information:  
[www.gelidsolutions.com](http://www.gelidsolutions.com)

#### Disclaimer:

In no event shall GELID Solutions its directors or employees be liable for any indirect damages, incidental or consequential damages arising from any defect or error in this manual or product.

© Copyright 2022 All rights reserved by GELID Solutions Limited  
All Brand names and Trademarks are the properties of their respective owners.